

**WEDNESDAY
01/04/2026**



Welcome to Zinvara Medicentre

Zinvara Medicentre Foundation is committed to improving access to affordable, compassionate, and community-centered healthcare for displaced and low-income populations. Our approach is rooted in equity, prevention, and sustainability, ensuring that no one is left behind in accessing essential health services. This first quarterly newsletter highlights our journey so far, the progress we have made, and the impact we are beginning to create within the communities we serve.

Our Journey So Far (January – March 2026)

Over the past three months, Zinvara Medicentre Foundation has transitioned from initial vision to tangible action through a series of impactful initiatives.



1. Community Health Outreach & Screening Initiative

We launched our first community outreach program on January 25th, 2026 by screening 50 displaced Nso taxi drivers in Yaoundé for non-communicable diseases. This initiative focused on:

- Early detection of health conditions
- Raising awareness on lifestyle-related diseases
- Promoting regular health check-ups among high-risk groups

Through this activity, we were able to engage directly with individuals who often have limited access to preventive healthcare services.

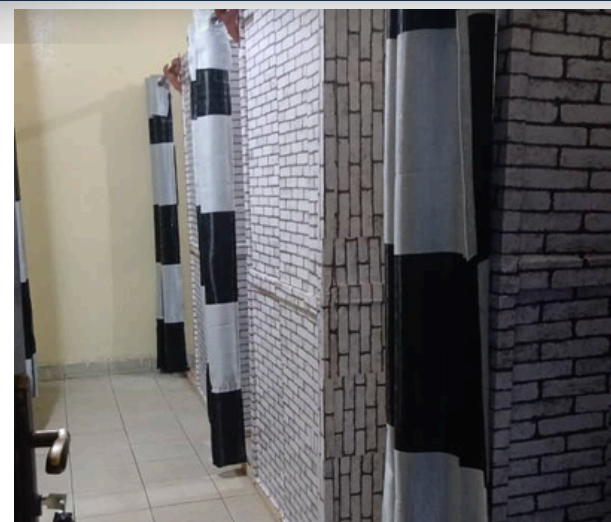

2. Establishment of a Physical Clinic

In our continued effort to improve access to care, we successfully established a physical office space, which now functions as a walk-in clinic.

This clinic serves as a safe and accessible point of care for:

- Displaced individuals
- Low-income families
- Community members in need of basic medical services

The walk-in clinic represents a major step in bringing healthcare closer to those who need it most.



WEDNESDAY
01/04/2026



3. Introduction of a Community Health Membership Model

To ensure sustainability and inclusivity, we introduced a community-based health membership system.

Under this model:

- Beneficiaries register for a small annual fee of \$1.7 USD
- Members gain access to free medical consultations
- Reduced costs are applied to additional healthcare services

This approach is designed to make healthcare affordable while maintaining the operational capacity of the foundation.



4. Community Awareness & Model Introduction Campaign

Following the introduction of our membership model, we organized a community outreach campaign to sensitize the public about our services. Within just one month:

- Over 100 individuals registered, including children and parents
 - Community members showed strong interest in accessing affordable healthcare
 - Awareness of preventive and primary healthcare services increased significantly
- This response highlights the relevance and acceptance of our approach within the community.

The Challenge We Are Addressing

In our continued effort to improve access to care, we successfully established a physical office space, which now functions as a walk-in clinic.

This clinic serves as a safe and accessible point of care for:

- Displaced individuals
- Low-income families
- Community members in need of basic medical services

The walk-in clinic represents a major step in bringing healthcare closer to those who need it most.

WEDNESDAY
01/04/2026



Upcoming Highlight: One Health Festival (April 12, 2026)

We are excited to announce our upcoming One Health Festival, scheduled to take place on April 12, 2026, at the Mvog-Mbetsi IDP Camp.

This event represents an important step in our commitment to promoting a holistic approach to health by integrating human, environmental, and community well-being.

What We Will Be Doing

During the festival, Zinvara Medicentre Foundation will:

- Conduct free health screenings for community members
- Deliver educational talks on proper waste management
- Promote hygiene and sanitation practices for disease prevention
- Raise awareness on the link between environmental health and human health



ZINVARA MEDICENTRE IN PARTNERSHIP WITH **ONE HEALTH FESTIVAL**

ONE HEALTH COMMUNITY OUTREACH

MVOG-MBETSI IDP CAMP, CAMEROON

APRIL 12, 2026 8:00 AM - 4:00 PM

WHAT TO EXPECT

- HEALTH EDUCATION
- MENTAL HEALTH SUPPORT

Looking Ahead

In our continued effort to improve access to care, we successfully established a physical office space, which now functions as a walk-in clinic.

This clinic serves as a safe and accessible point of care for:

- Displaced individuals
 - Low-income families
 - Community members in need of basic medical services
- The walk-in clinic represents a major step in bringing healthcare closer to those who need it most.

Join Us

Zinvara Medicentre Foundation continues to grow as a community-driven initiative dedicated to improving lives through accessible healthcare.

We invite you to:

- Visit our website
- Learn more about our work
- Partner with us or support our initiatives
- Share our mission within your network

Closing Message : This quarter marks the beginning of a meaningful journey toward building healthier and more resilient communities

